

### Filter housing Bag filter AFB

#### 1. Introduction

For a wide number of filtration applications bag filters are a simple, easy to use and economical choice. MAHLE Industrial filtration supplies a wide range of filter bags and bag filter housings. The AFB bag filter housings are available for size 1 and size 2 filter bags and manufactured from carbon steel or stainless steel.

Our bag filters are excellent for use in the filtration of liquids containing higher concentrations of coarse solids. They are particularly beneficial when handling batches of (various) liquids. They are also especially suitable for end filtration or polishing of liquids with extremely low concentrations of solids.



## 2. Features

- Easy to use, good interior sealing and accessibility.
- Cover closing with hinged eye bolts and eye nuts (galvanised steel). Stainless steel bolts and nuts optional.
- Flat cover with handle.
- O-ring sealing: standard Buna N. Other materials on request.
- Strong stainless metal mesh support basket for low flow resistance and maximum utilisation of entire surface area.
- Slightly conical support basket for easy filter bag removal. Liquid displacement cover: no liquid runs over the side when opening the filter.
- Liquid displacer units are available to further reduce the dead volume inside the filter bags.
- Perfect sealing between unfiltered liquid and filtered liquid is achieved by a spring-loaded hold-down device onto the filter bag and support basket. The filter bag seals with a felt-covered Snap-Collar ring or plastic seal which tightly fits into the support basket.
- Height-adjustable legs.

## 4. Filter bags

MAHLE Industrial Filtration supplies a wide range of filter bags in different materials, pore sizes, dimensions and models to fit in our amafilter housings as well as those of other manufacturers.

For detailed information about amaFlow filter bags, please see respective Data Sheets.

## 3. Standard specifications

Design pressure	: 0 / 10 bar(g)
Design temperature	: 0 / 90 °C
Operating temperature	: depending on the filter media and gaskets used
PED 97/23/EC cat.	: article 3 paragraph 3
Maximum differential pressure	
design	: 4.0 bar
operating	: 2.5 bar

## 5. Options

### *Strainer baskets*

The filter housings can be equipped with stainless steel filter baskets in several mesh sizes. The filter housings can then be used as strainers.

### *Special models to suit customer requirements*

Other options of supply and manufacture are non-standard types for higher temperatures, pressures and other materials according to current design codes, available on request.

## 6. Dimensions

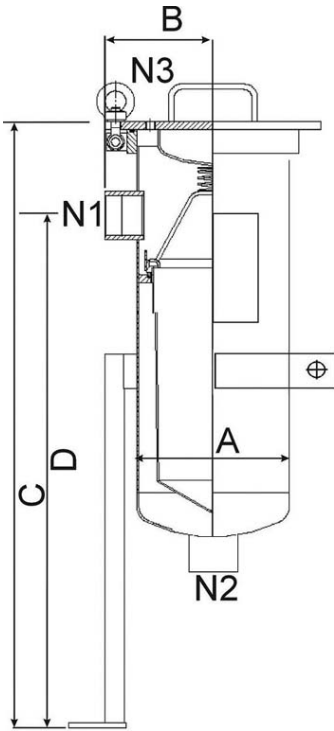

### Nozzle specification

N1 :	Inlet
N2 :	Outlet
N3 :	Vent (Rp ¼ - ISO7-1)

### Dimensions

Size	Diameter [mm] A	Standout [mm] B	Height [mm] C	Nozze height [mm] D	Volume [dm³]	Weight [kg]
90	219	156	max. 1020	max. 895	19	max. 21
180	219	Threaded: 156 Flanged: 210	max. 1370	max. 1245	34	max. 33

Dimensions are for reference only. Use dimensional drawing for installation purposes.  
Subject to technical alteration without prior notice.

## 7. Ordering code

Example

AFB 180 T 2F

### amafilter type

AFB

### Size

90 = for bag size 1

180 = for bag size 2

### Material

No symbol = carbon steel

T = 316Ti (1.4571)

TY = 316Ti (1.4571) with stainless steel bolts and nuts

### Inlet/outlet

2 = Rp2 - ISO7-1

2F = DN50 acc. EN1092/PN16

Size 180 only

2B = Ø52.1x1.5 acc. DIN11850

3F = DN80 acc. EN1092/PN16

ASME 150 lbs RF on request (FA)

# MAHLE

*Industrial Filtration*

MAHLE Industrial Filtration (Benelux) B.V.  
P.O.Box 396 1800 AJ  
Alkmaar - The Netherlands  
Phone +31 (0) 72 5273400  
Fax +31 (0) 72 5125207  
mahle.amafilter@mahle.com  
www.mahle-industrialfiltration.com  
10/2009